

Salix Gripple TL-P1S

The TL-P1 holds all types of erosion control and soil stabilisation blanket matting securely in place.

FEATURES / BENEFITS

- Quick and easy to install with a standard electric drill
- Superior performance when compared to traditional straight pins
- Eliminates time & labour associated with replacing or reworking pins that have become loose or pulled out altogether
- The patent pending innovative design of the installation chuck allows the TL-P1 to be installed to full depth without damaging the mat
- Integrated top coil form eliminates the need for a washer, spreads the load and helps secure the matting in place
- Extended tip allows faster placement and enhanced interaction with matting on install



SPECIFICATION

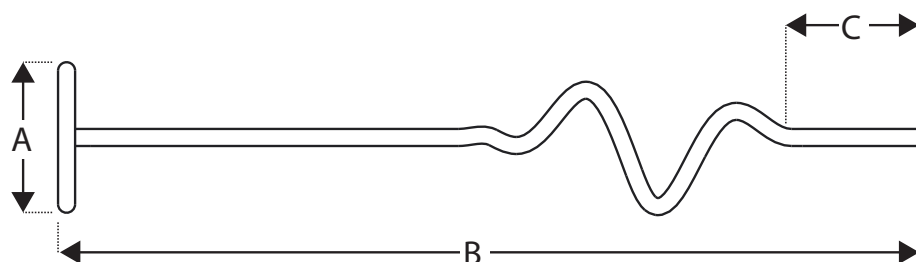

Dimension	Length (mm)
A	35
B	200
C	28

INSTALLATION TOOLS



Chuck
(90 mm)



Extended Chuck
(490 mm)

CHUCK ASSEMBLY

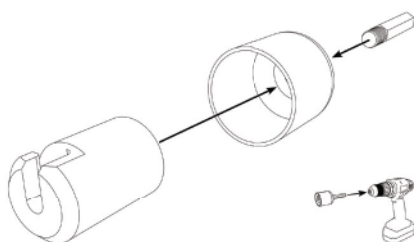

INSTALLATION

1.

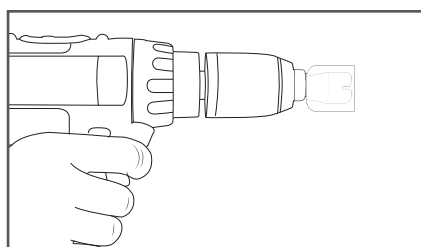

2.

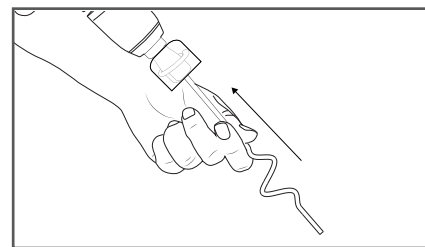

3.

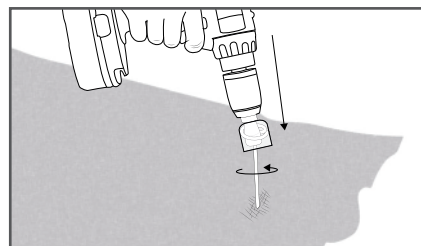

4.

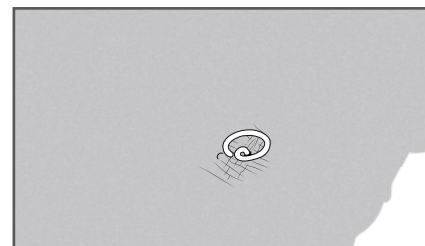

Proper considerations should be given to underground services before installing.